

# Tallest Tower

Build Instructions



The section at the top of the step shows important information for the build.



1x - 2x12 Beam



6x

1x1

Connector Pins



1x - Smart Motor

The first number under the part (1x, 2x, 4x, etc) is the number of that piece you will need in this step.

The next information under the part image is the size (if necessary) and name of the part needed.

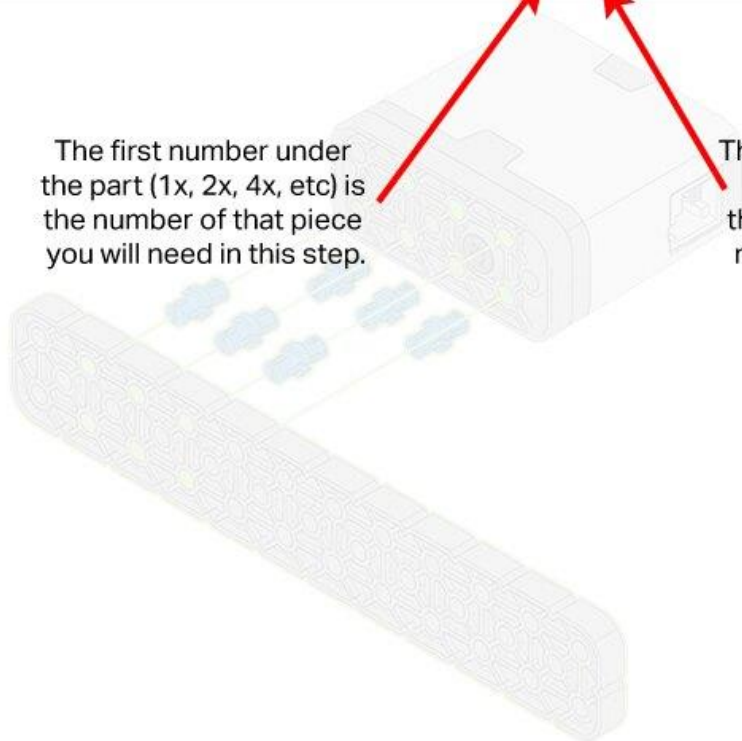

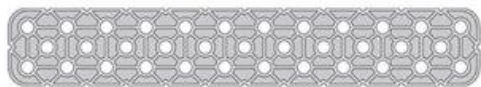

1x - 2x12 Beam



6x - 1x1 Connector Pins



1x - Smart Motor

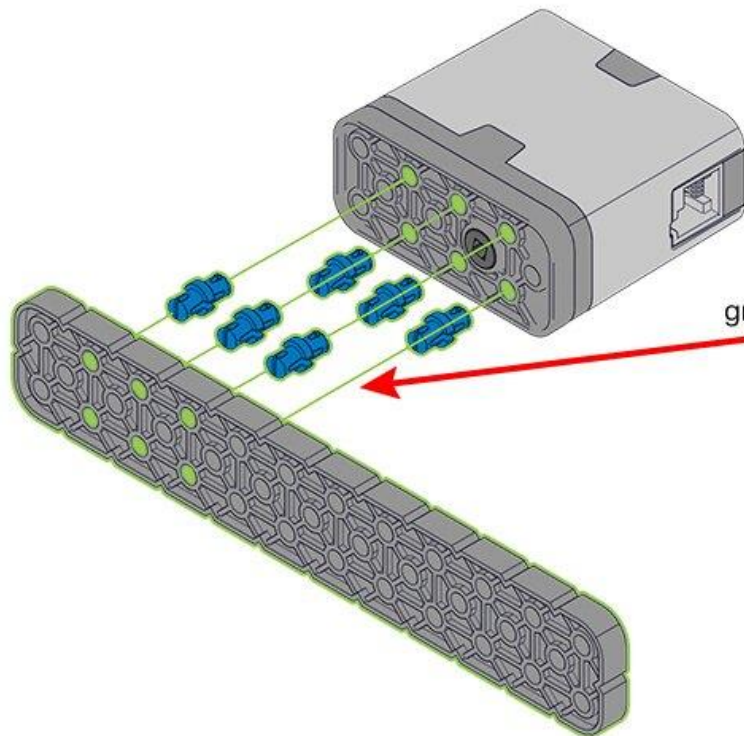

Pay close attention to the green lines in the step images.

They will indicate how the parts should be connected.

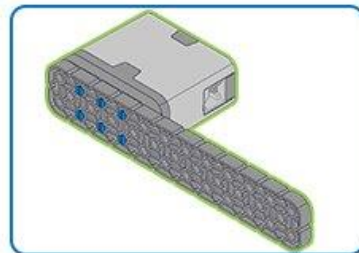



1x - 2x Wide, 1x2 Offset Corner Connector



1x - Smart Motor

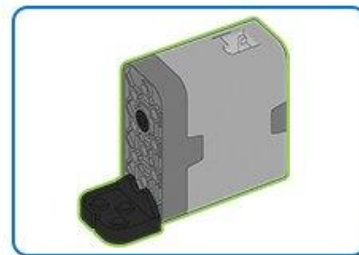
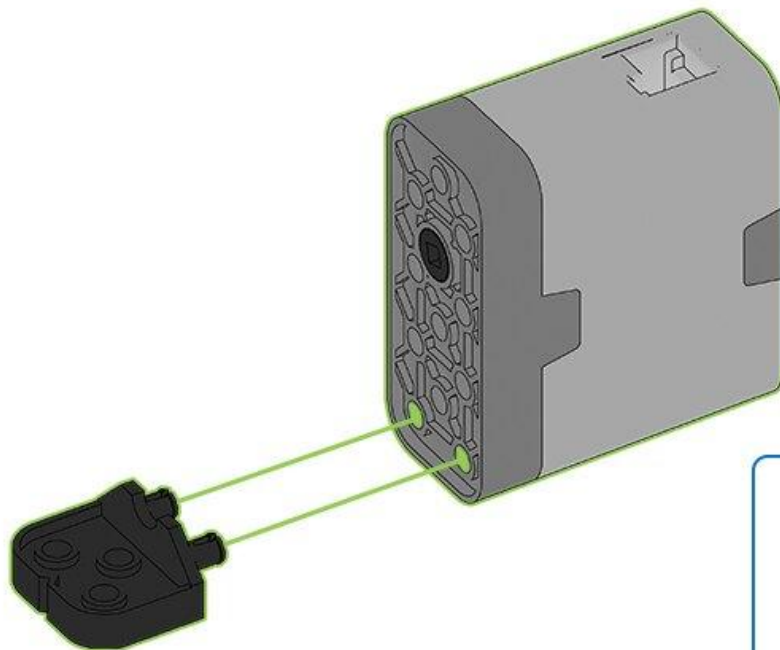

2



1x - 4x Pitch Shaft

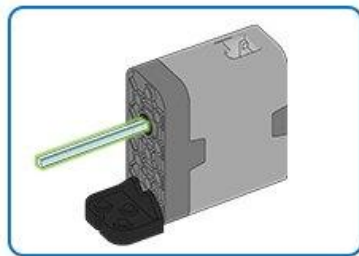
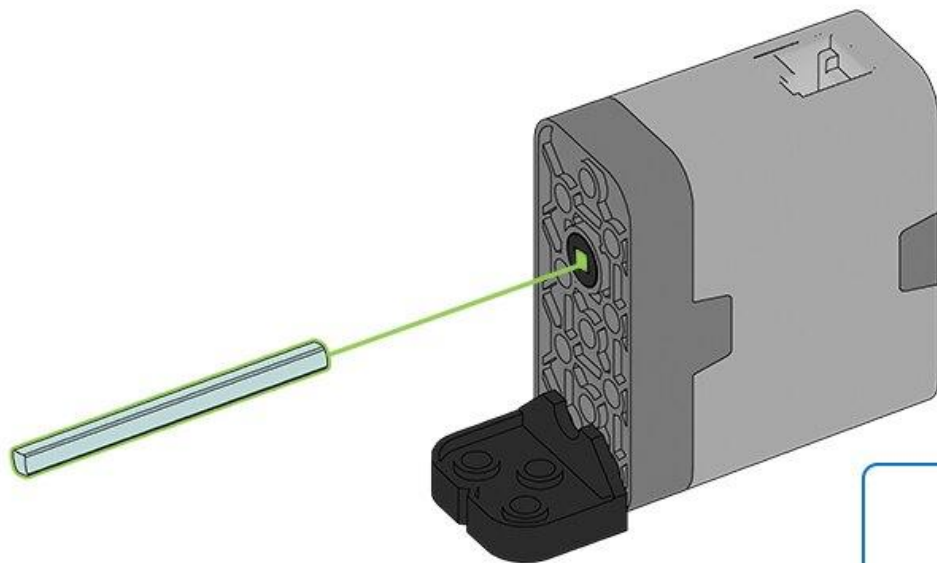

3



2x - Rubber Shaft Collars



1x - 60 Tooth Gear

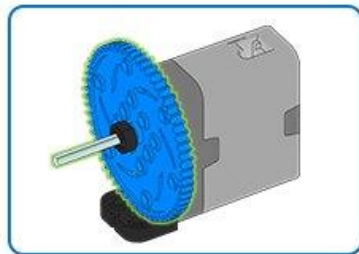
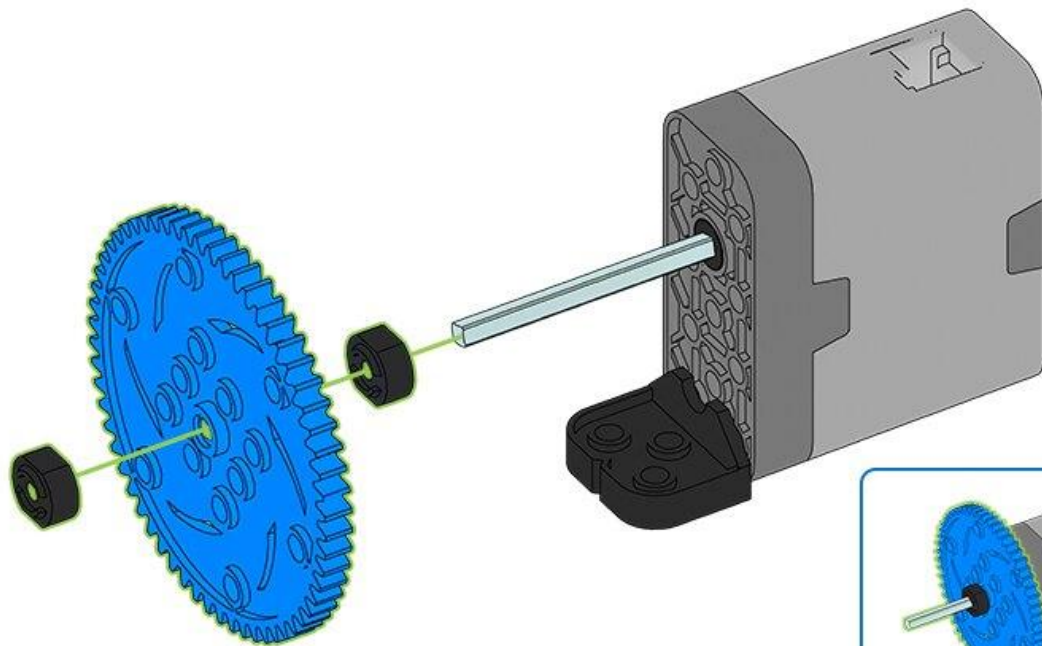

4



1x - 1x1 Connector Pin



1x - 1x3 Shaft Lock Plate

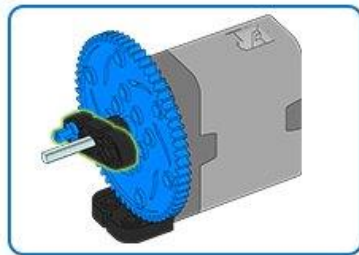
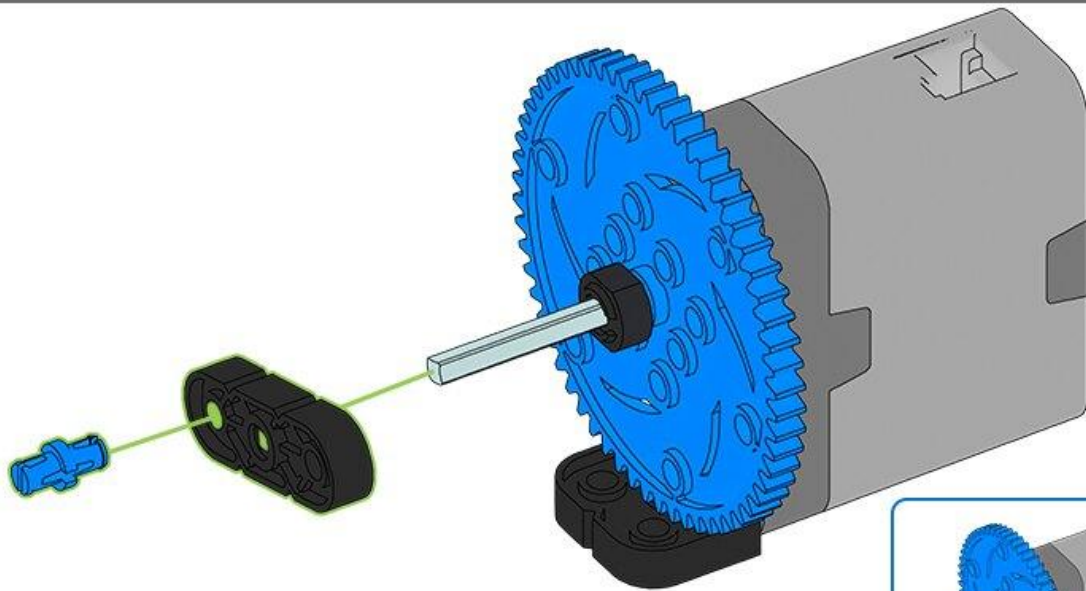

5

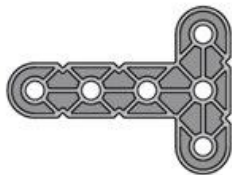

1x - 3x4 Tee Beam

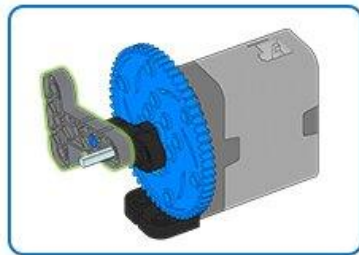
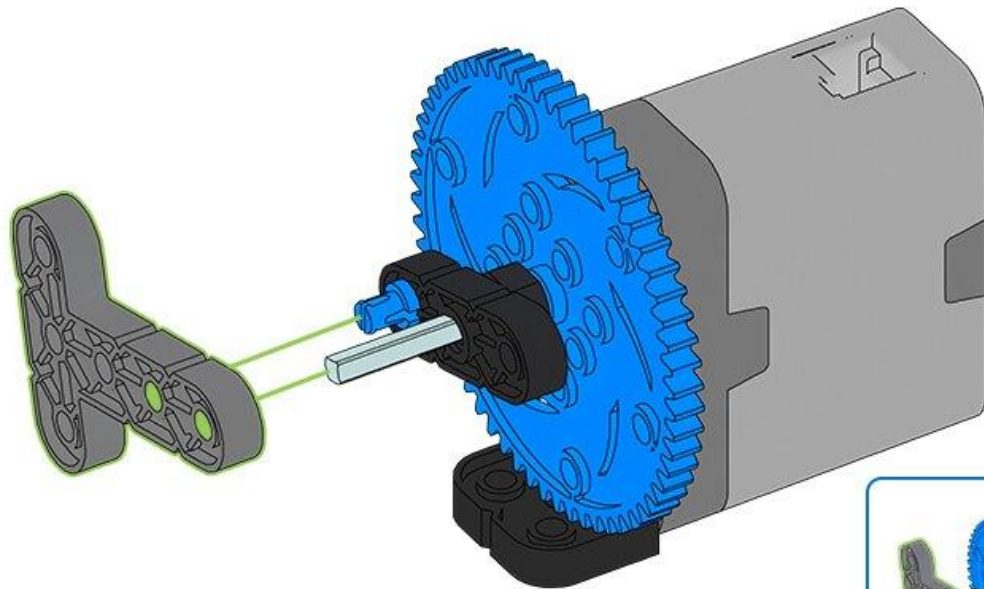

6



1x - Rubber Shaft Collar

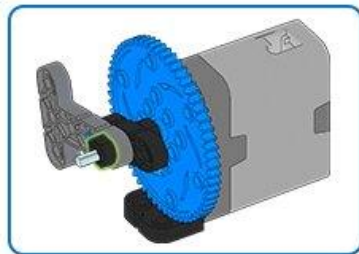
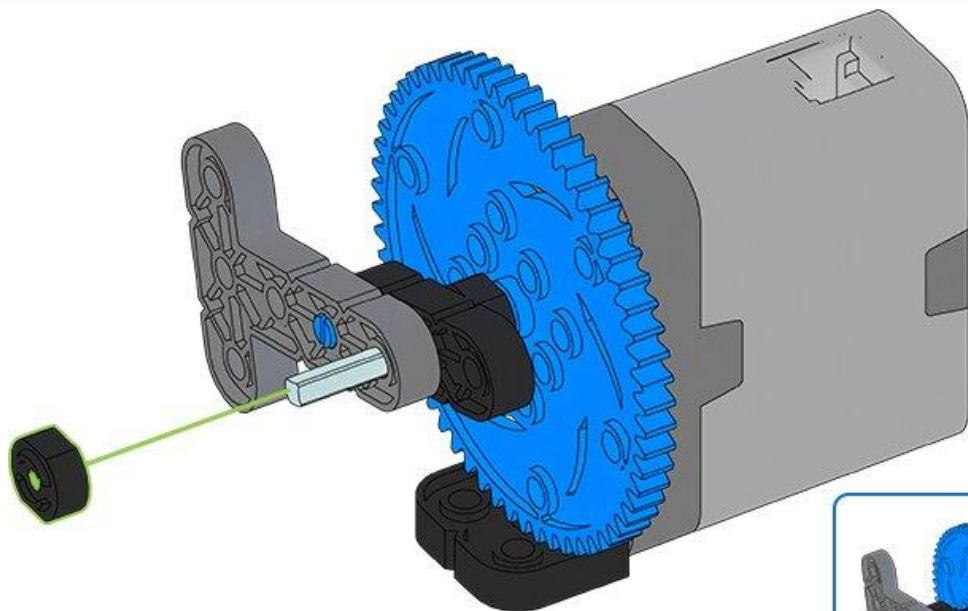

7



6x - 1x2 Connector Pins



2x - 1x10 Beams



1x - 1x8 Beam

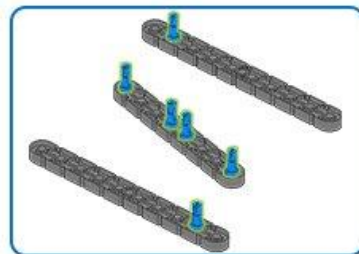
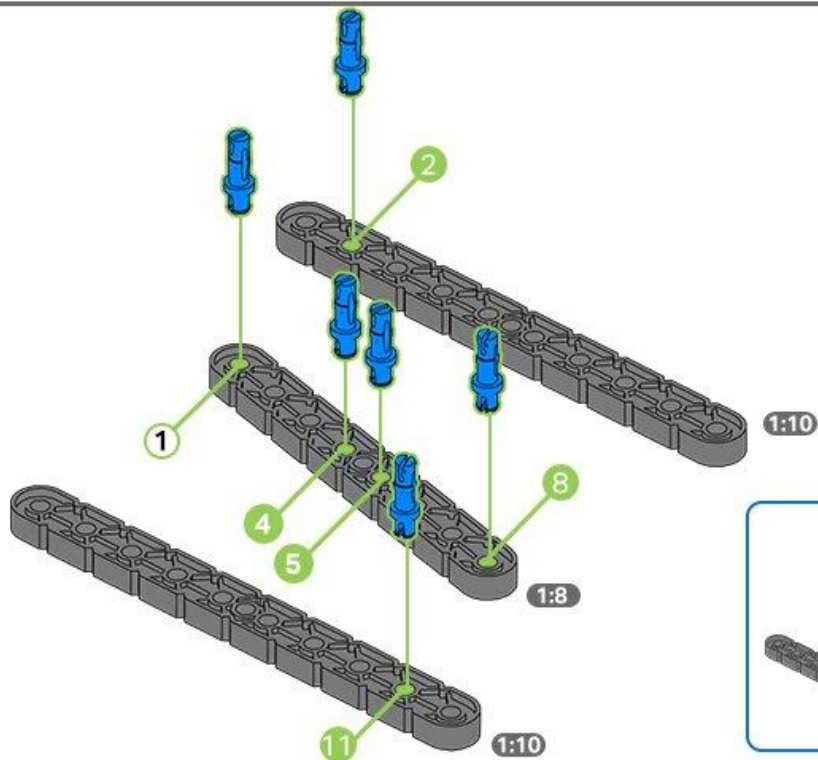

8



2x - 30 Degree Angle Beams

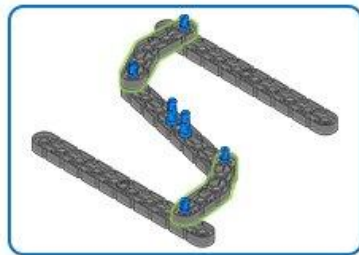
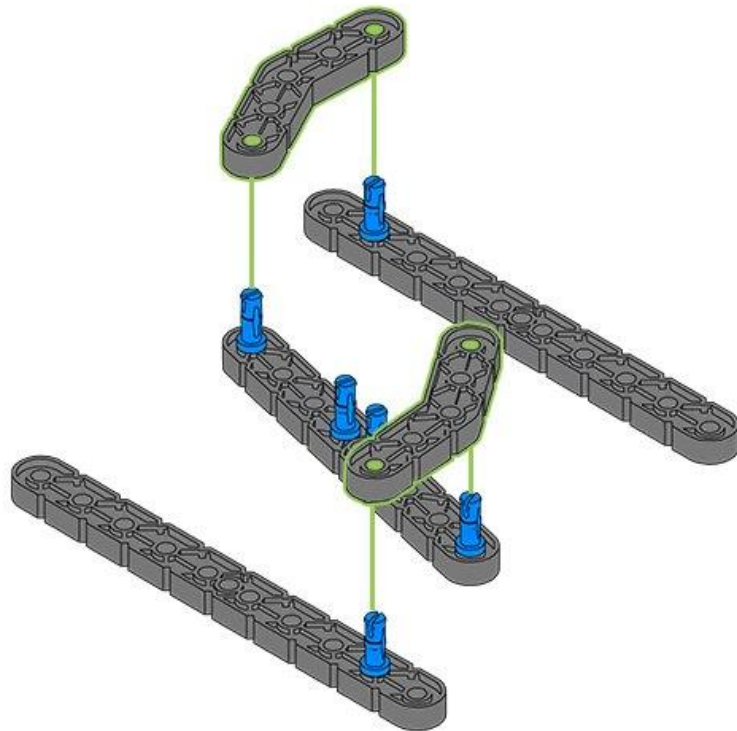

9

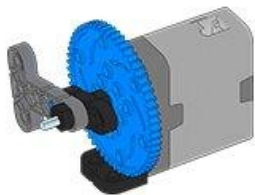

1x - Step 6 Assembly

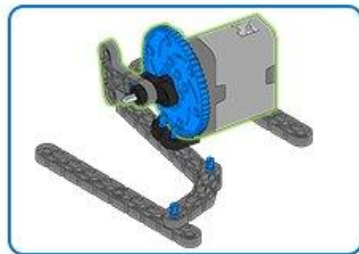
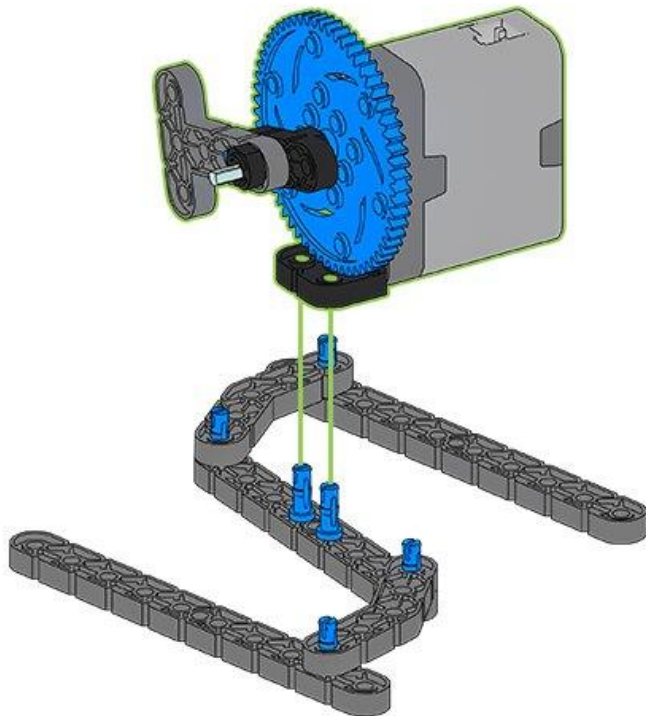

10



1x - Smart Radio



1x - Robot Brain



1x - Robot Battery

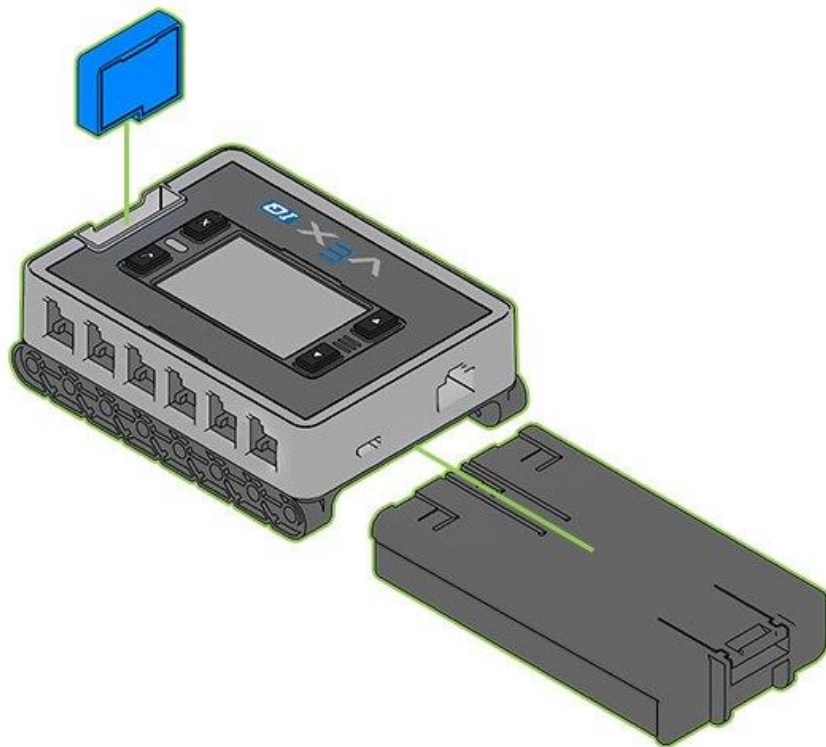

11



1x - 400mm Smart Cable

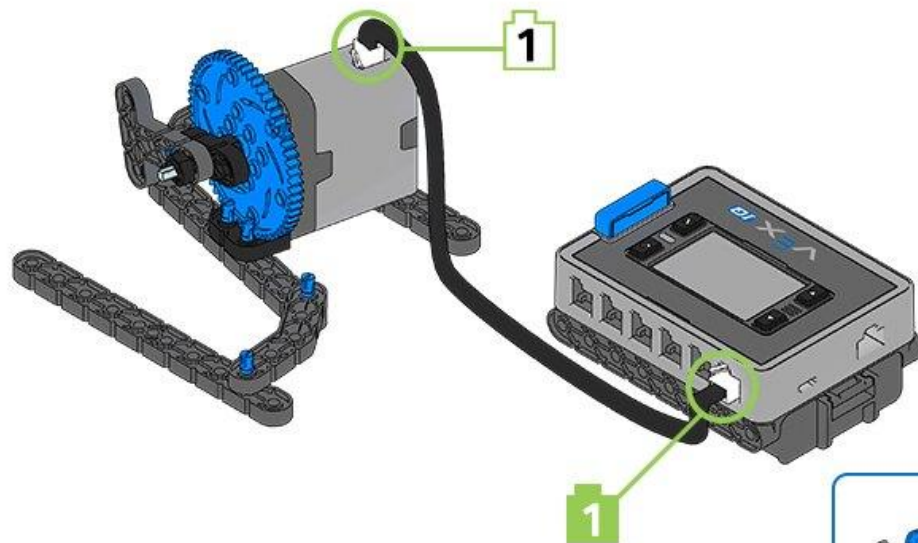



**4x - 6x Pitch Standoffs**



13



2x - 2x12 Beams



14



24x - 1x1 Connector Pins



2x - 1x12 Beams

2x

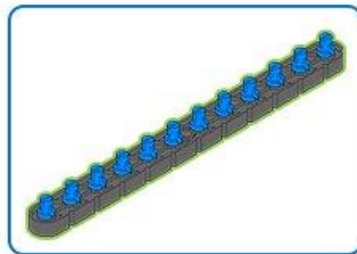
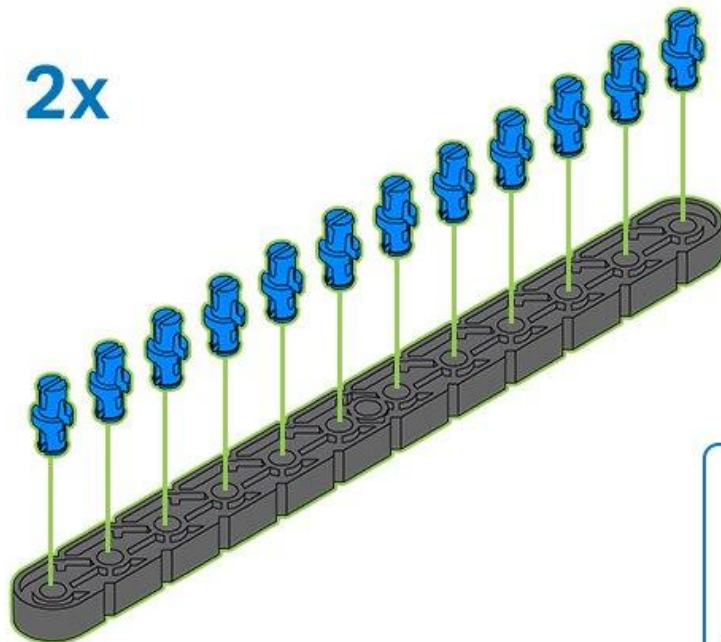

15



1x - Step 14 Assembly

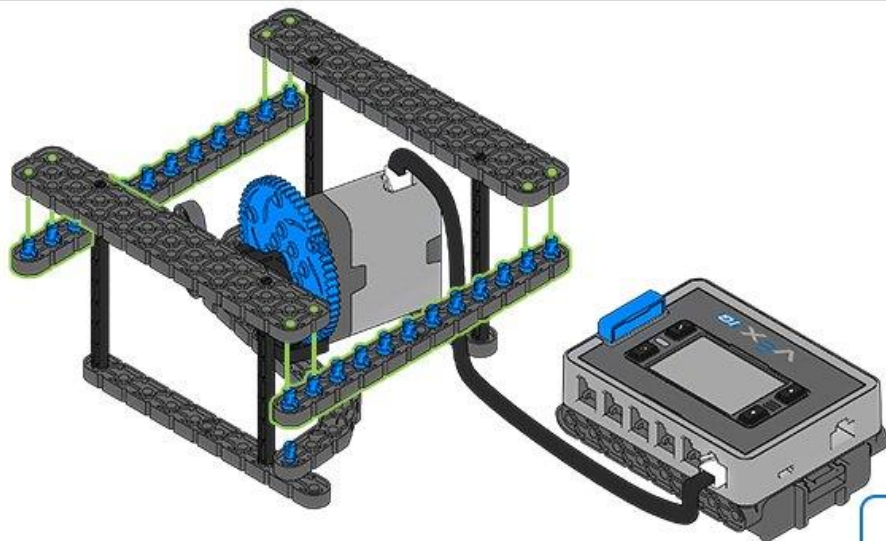

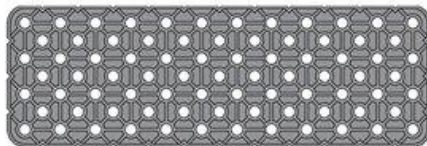

2x - 4x12 Plates

